



Grand Tudor in San Mateo Park



641 CRESCENT AVENUE **SAN MATEO PARK**

In the heart of sought-after San Mateo Park, this stately circa 1924 Tudor reflects the enduring character and architectural grace that define one of the Peninsula's most treasured neighborhoods. Timeless details – richly paneled walls, leaded glass accents, decorative ceiling, and fine millwork – are complemented by thoughtful updates, including a remodeled kitchen, beautifully renovated primary suite bath, and upstairs carpet. Grand formal living and dining rooms are balanced by everyday comfort in the expansive family room, which opens fully to the kitchen for modern living, and the four bedrooms are all arranged upstairs. The entire home is bright and light with excellent proportions for today's lifestyle. The approximately one-third-acre lot offers exceptional outdoor space with a fireplace courtyard, large rear yard, raised garden beds, and a charming Western-themed barn. Ideally located between downtown San Mateo and Burlingame, this home offers classic elegance in a premier setting.





SUMMARY OF THE HOME

- 4 bedrooms and 3 baths on two levels
- Approximately 3,680 square feet (per County records)
- Approximately one-third acre (14,585 square feet per County records)
- Raised panel front door flanked by leaded glass sidelights
- Classic foyer with richly hued wood paneling on two sides and wrapping around the central staircase; hardwood floors continue throughout the main living areas; carpet finishes the upper level
- Grand formal living room with decorative pressed-pattern ceiling, leaded glass windows, and focal point fireplace with tiled mantelpiece beneath sconce lighting
- Formal dining room with ceiling light and expansive recessed window with deep ledge and views to the courtyard fireplace
- Remodeled kitchen features white cabinetry and contrasting angular island, all topped in granite slab with glass tile backsplashes
- Appliances include a Dacor 6-burner gas cooktop, Dacor oven, Kenmore microwave, Samsung dishwasher, and Sub-Zero refrigerator
- Family room and casual dining area, fully open to the kitchen, with sliding glass door to the courtyard with fireplace and double French doors to the rear grounds
- Bath with pedestal sink and tub with overhead shower
- Upstairs primary suite with walk-in closet and remodeled bath with dual-sink vanity, tub, shower, and private commode room
- Three additional upstairs bedrooms, one with built-in Murphy bed, are served by an updated bath with dual-sink vanity and frameless-glass shower
- Detached 2-car garage with workshop, sink, and EV charging outlet
- Other features: upstairs air conditioning; Bosch washer and dryer concealed in the upstairs hallway; partial basement for storage
- Extra-deep lot includes a spacious side patio with fireplace (available for use with propane tank) and large rear yard with brick patios, raised gardening beds, and Western-themed barn

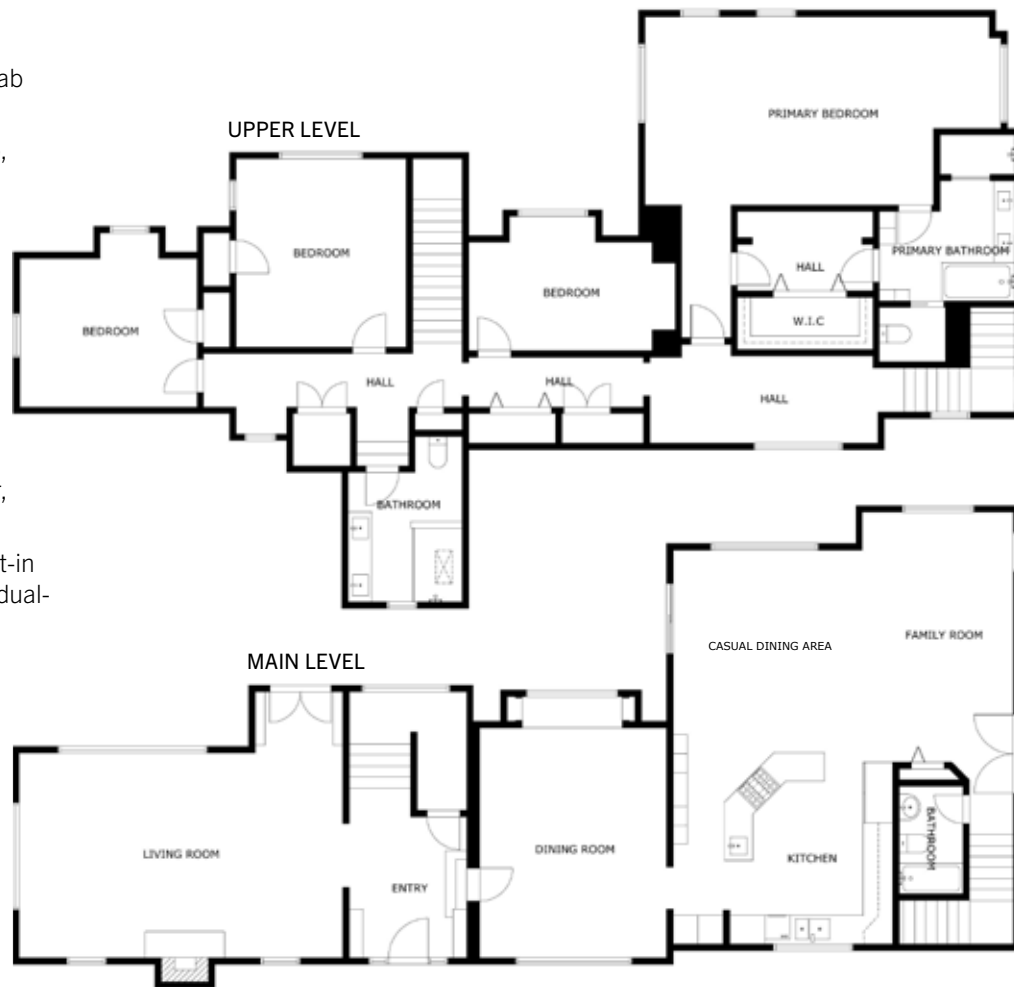

Floor plan is for illustrative purposes only. Room dimensions, living area are approximate.

Offered at \$5,250,000 | 641Crescent.com

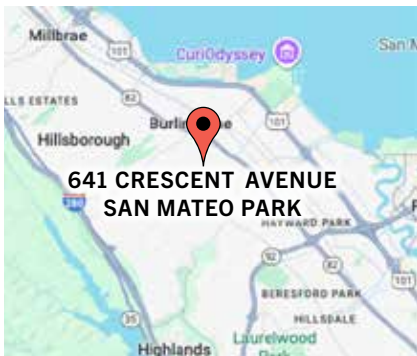

CLOSE TO...

- Downtown Burlingame..... 0.5 mi 2 min
- Caltrain..... 1.0 mi 4 min
- Downtown San Mateo..... 1.6 mi 5 min
- Highway 101..... 1.6 mi 5 min
- Mills Peninsula Health Svcs..... 2.9 mi 8 min
- San Francisco Int'l Airport 4.5 mi ... 12 min

(all times and distances are approximate; information provided by Google Maps)

MARK JOHNSON

Broker Associate | CaRE# 00667906

650.619.2828

Mark@MarkWJohnson.net

www.MarkWJohnson.net



COLDWELL BANKER
REALTY

